



# CMC 515 URBAN PLANNING

ASSOCIATED PROFESSOR/ MONA Y. SHEDID

## LECTURE 8: THE NEIGHBORHOOD; A RESIDENTIAL ENVIRONMENT

**THE  
NEIGHBORHOOD;  
A RESIDENTIAL  
ENVIRONMENT ?????**



# CONTENT

- COMPONENTS OF NEIGHBORHOOD
- ASSIGNMENT 4

# INTRODUCTION

FROM THE PREVIOUS MODEL WE WILL STUDY THE FOLLOWING POINTS

**SERVICES (CENTER)**

**OPEN SPACES**

STREETS

RESIDENTIAL CLUSTERS

# COMPONENTS OF NEIGHBORHOOD

## ➤ THE SERVICE CENTERS

### ❖ THE SERVICE CENTER HIERARCHY:

1. Neighborhood Center
2. District Center
3. Main Center

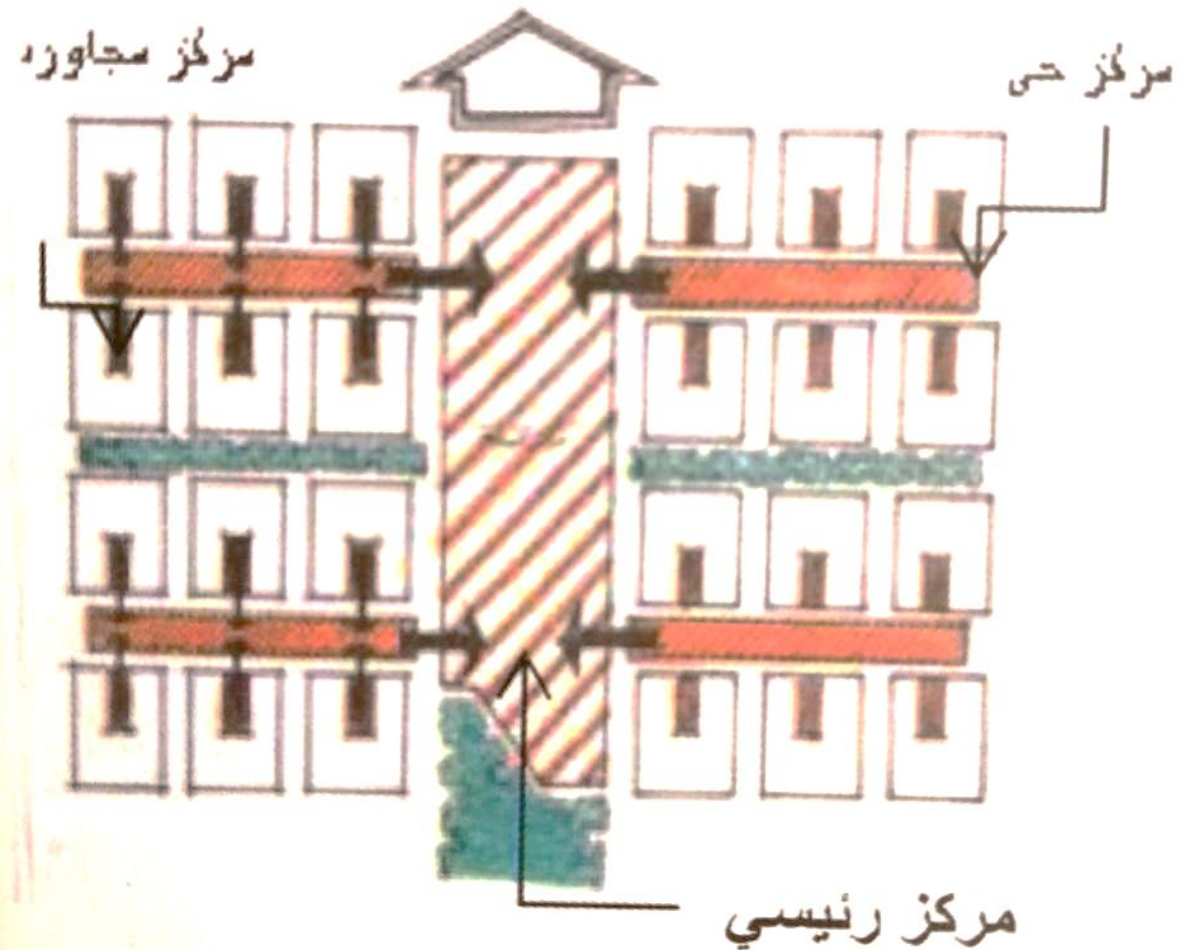

# COMPONENTS OF NEIGHBORHOOD

## ➤ THE SERVICE CENTERS

### TYPES OF SERVICE CENTERS

DAILY CENTERS

WEEKLY CENTERS

MONTHLY CENTERS

YEARLY CENTERS



EDUCATIONAL  
ENTERTAINMENT  
RELIGIOUS  
COMMERCIAL  
OPEN SPACES



**THE NEIGHBORHOOD SERVICE CENTERS**

# COMPONENTS OF NEIGHBORHOOD

## ➤ THE SERVICE CENTERS

### ❖ Design Principles:

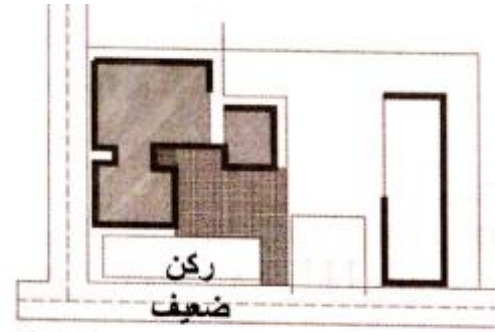
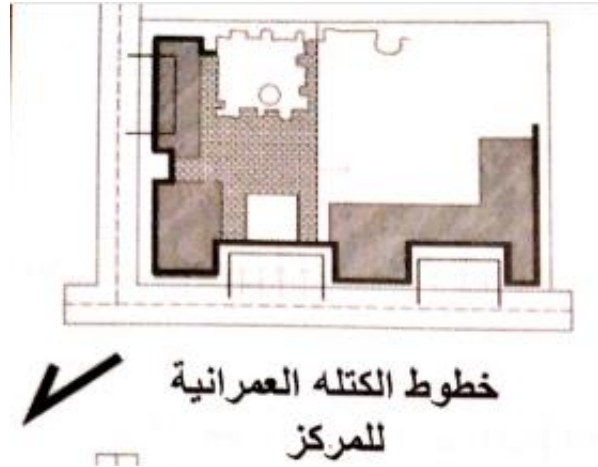

**X** الكتل غير متصلة وأركان المركز ضعيفة

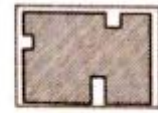

مباني  
خدمات  
المركز تكون  
كتله متكاملة

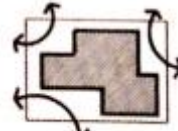

مباني  
خدمات  
المركز تكون  
كتله ذات  
اركان  
ضعيفة

1. تتوزع الاستعمالات المختلفة داخل المساحة المخصصة له على أن يتوسطها ساحة داخلية.
2. أن يكون له اركان قوية من الناحية البصرية.
3. تتكامل الخدمات مع الطرق المحيطة مع تحديد مداخل ومخارج المركز.
4. توفير الاماكن المخصصة للتخديم.
5. توفير العدد الكافي لمواقف السيارات طبقا لاعداد المترددين على المراكز أو عدد المحلات أو مساحتها.

# COMPONENTS OF NEIGHBORHOOD

## ➤ THE SERVICE CENTERS

### ❖ Design Principles:

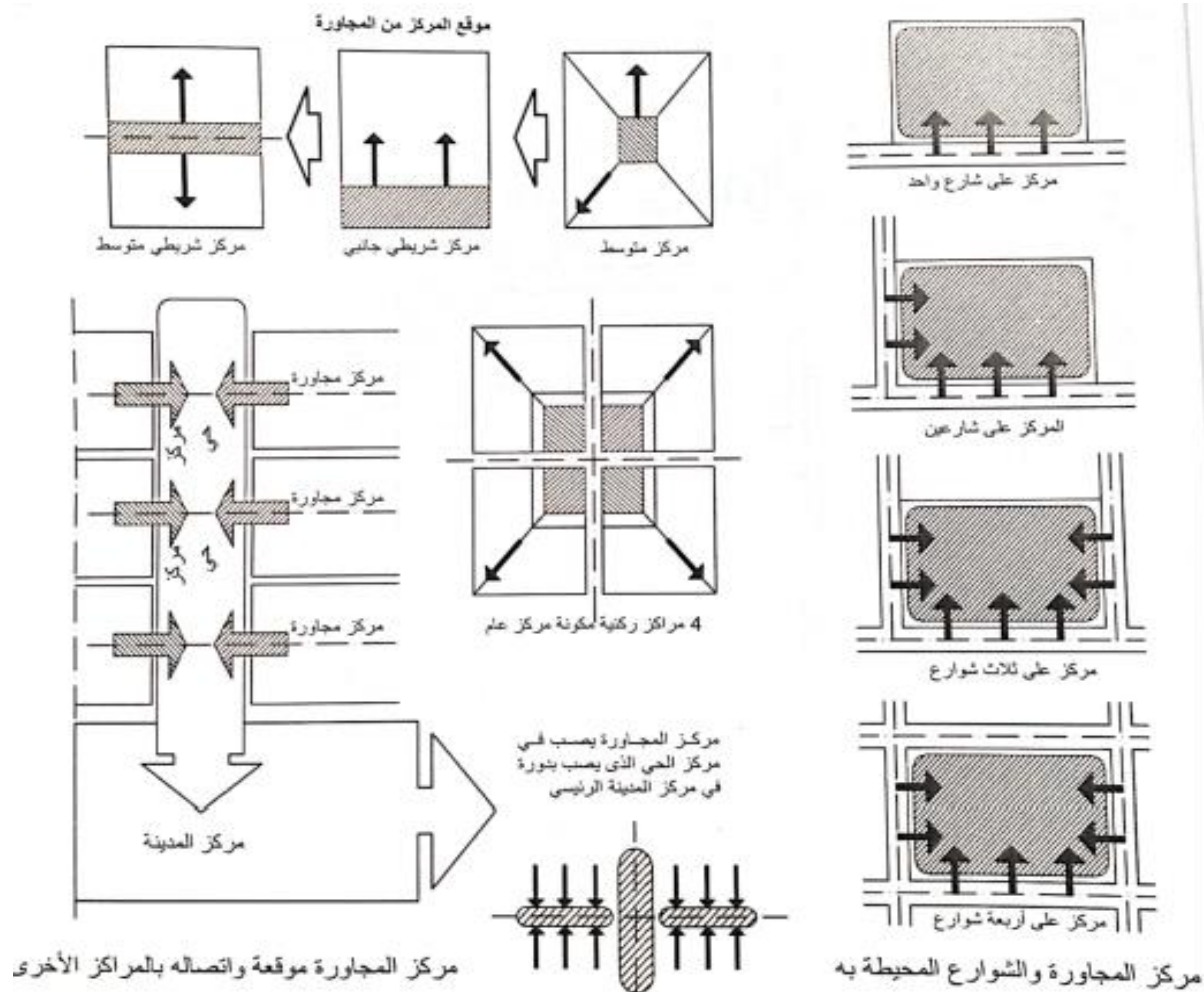



# COMPONENTS OF NEIGHBORHOOD

## ➤ THE SERVICE CENTERS

### ❖ Design Principles:

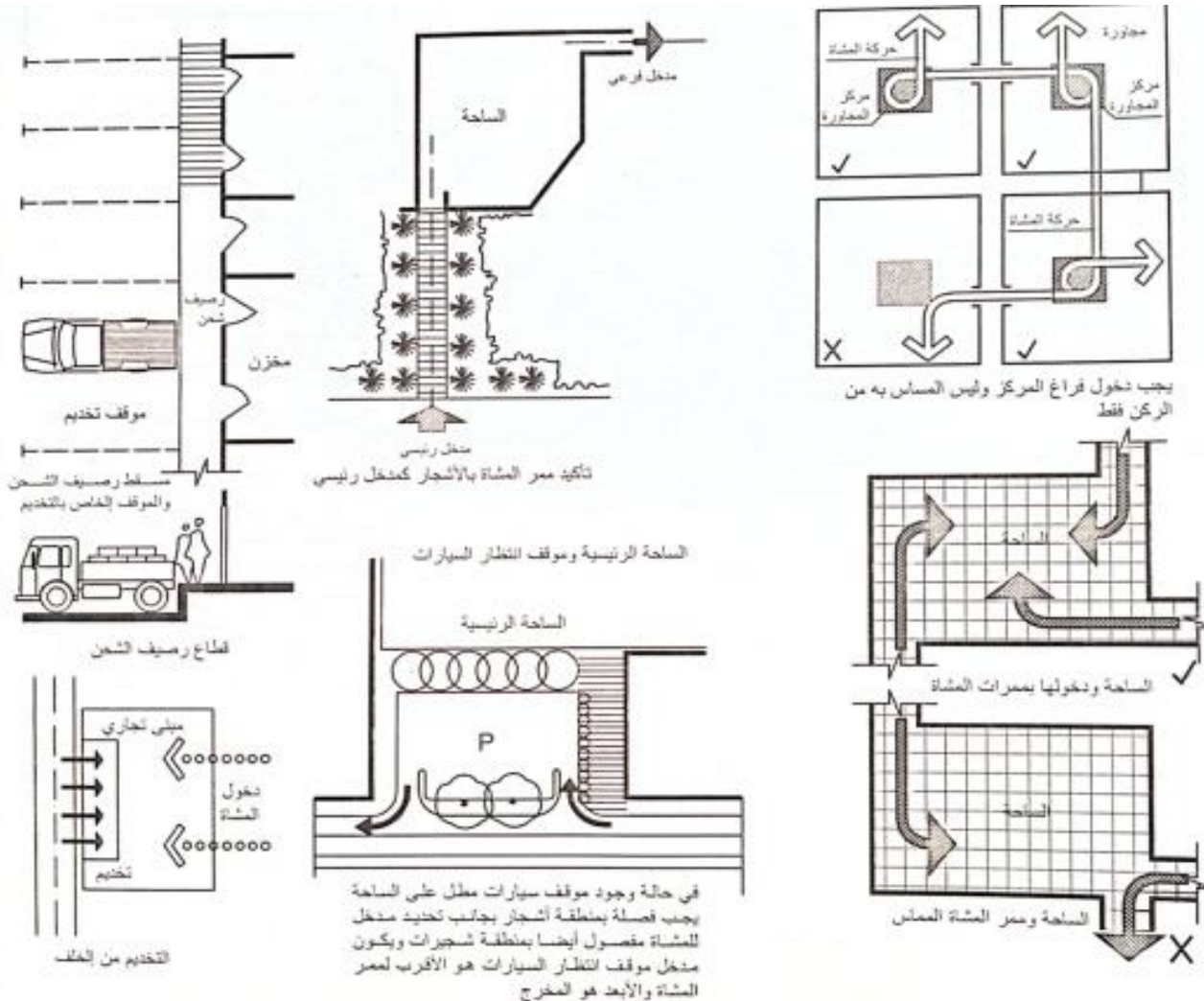

# COMPONENTS OF NEIGHBORHOOD

## ➤ THE ELEMENTS DEFINING SPACE

### ❖ Horizontal Elements Defining Space:

1- **BASE PLANE:** Defines a simple field of space.

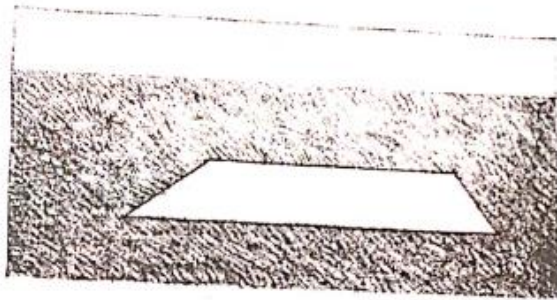

2- **DEPRESSED BASE PLANE:** Define a volume of space.

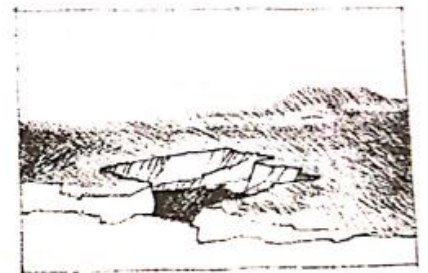
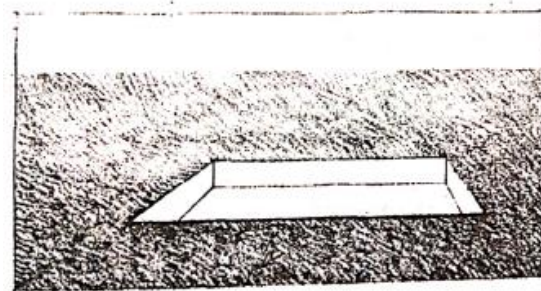

# COMPONENTS OF NEIGHBORHOOD

## ➤ THE ELEMENTS DEFINING SPACE

### ❖ Horizontal Elements Defining Space:

3- **ELEVATED BASE PLANE:** Reinforce the visual separation between its field and the surrounding ground.

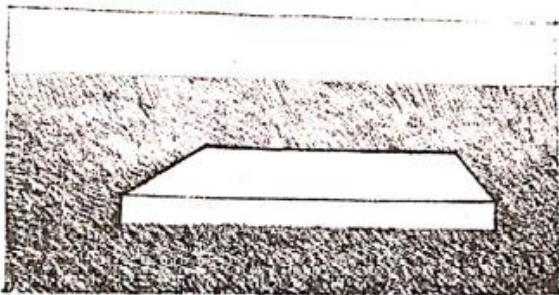

4- **OVERHEAD PLANE:** Defines a volume of space between itself and the ground plane.

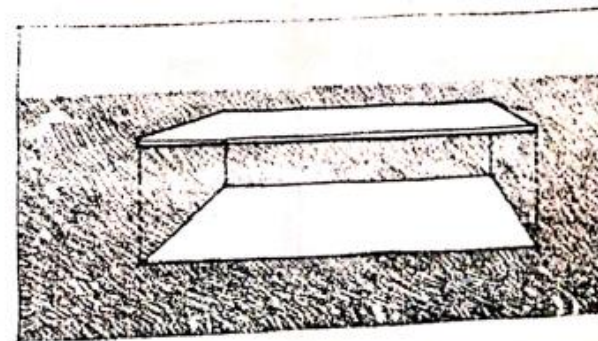

# COMPONENTS OF NEIGHBORHOOD

## ➤ THE ELEMENTS DEFINING SPACE

### ❖ Horizontal Elements Defining Space: **BASE PLANE:**

It's a horizontal plane lying on a floor



# COMPONENTS OF NEIGHBORHOOD

## ➤ THE ELEMENTS DEFINING SPACE

❖ Horizontal Elements Defining Space: **BASE PLANE:**



# COMPONENTS OF NEIGHBORHOOD

## ➤ THE ELEMENTS DEFINING SPACE

❖ Horizontal Elements Defining Space: **DEPRESSED BASE PLANE:**



# COMPONENTS OF NEIGHBORHOOD

## ➤ THE ELEMENTS DEFINING SPACE

### ❖ Horizontal Elements Defining Space: **ELEVATED BASE PLANE**



# COMPONENTS OF NEIGHBORHOOD

## ➤ THE ELEMENTS DEFINING SPACE

### ❖ Horizontal Elements Defining Space: **ELEVATED BASE PLANE**





# COMPONENTS OF NEIGHBORHOOD

## ➤ THE ELEMENTS DEFINING SPACE

### ❖ Horizontal Elements Defining Space: **ELEVATED BASE PLANE**

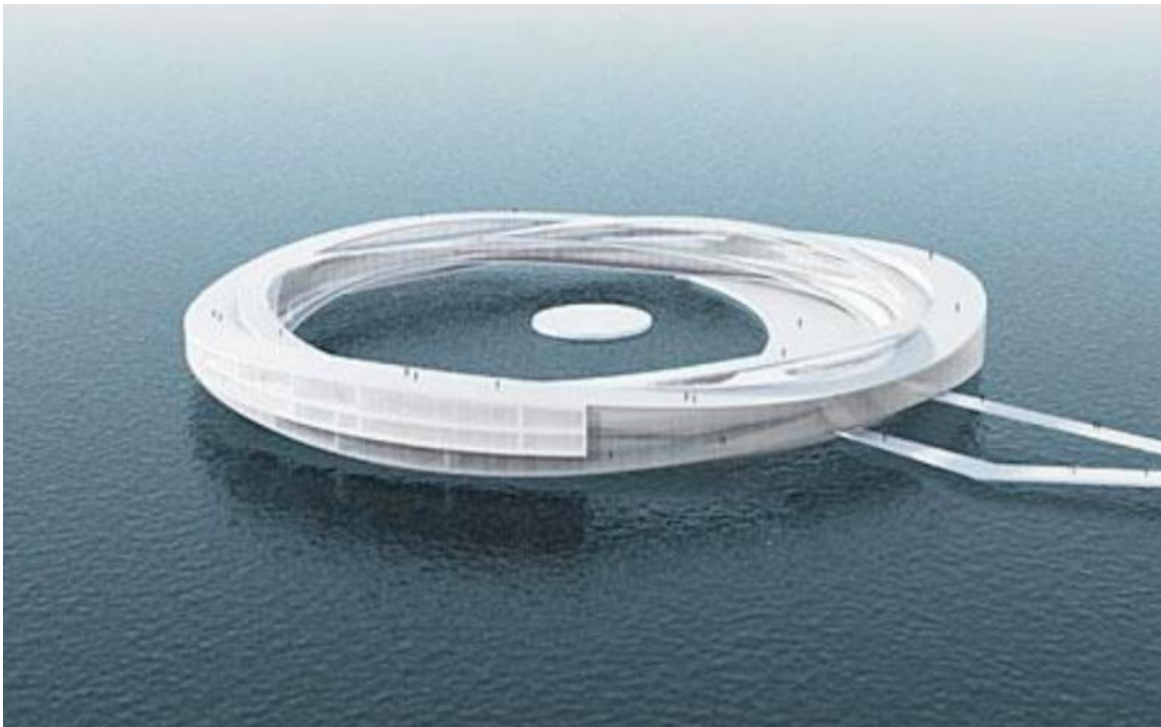

# COMPONENTS OF NEIGHBORHOOD

## ➤ THE ELEMENTS DEFINING SPACE

### ❖ Horizontal Elements Defining Space: **OVERHEAD PLANE**

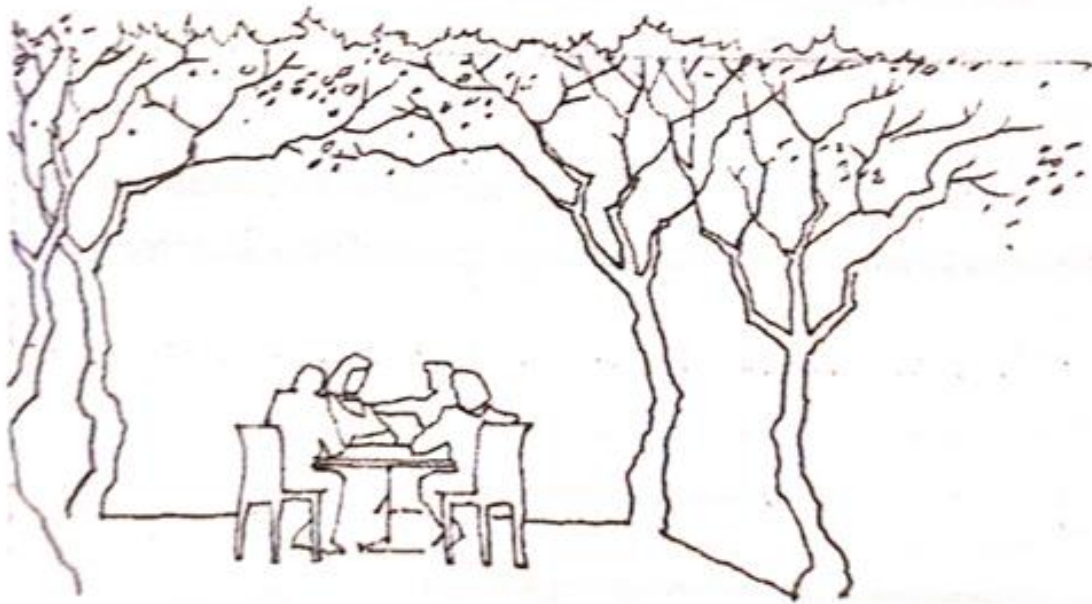

*A bosket or grove of trees defining a shady place in a garden or park.*



# COMPONENTS OF NEIGHBORHOOD

## ➤ THE ELEMENTS DEFINING SPACE

### ❖ Exercise



# COMPONENTS OF NEIGHBORHOOD

## ➤ THE ELEMENTS DEFINING SPACE

### ❖ Exercise



# COMPONENTS OF NEIGHBORHOOD

## ➤ THE ELEMENTS DEFINING SPACE

### ❖ Exercise

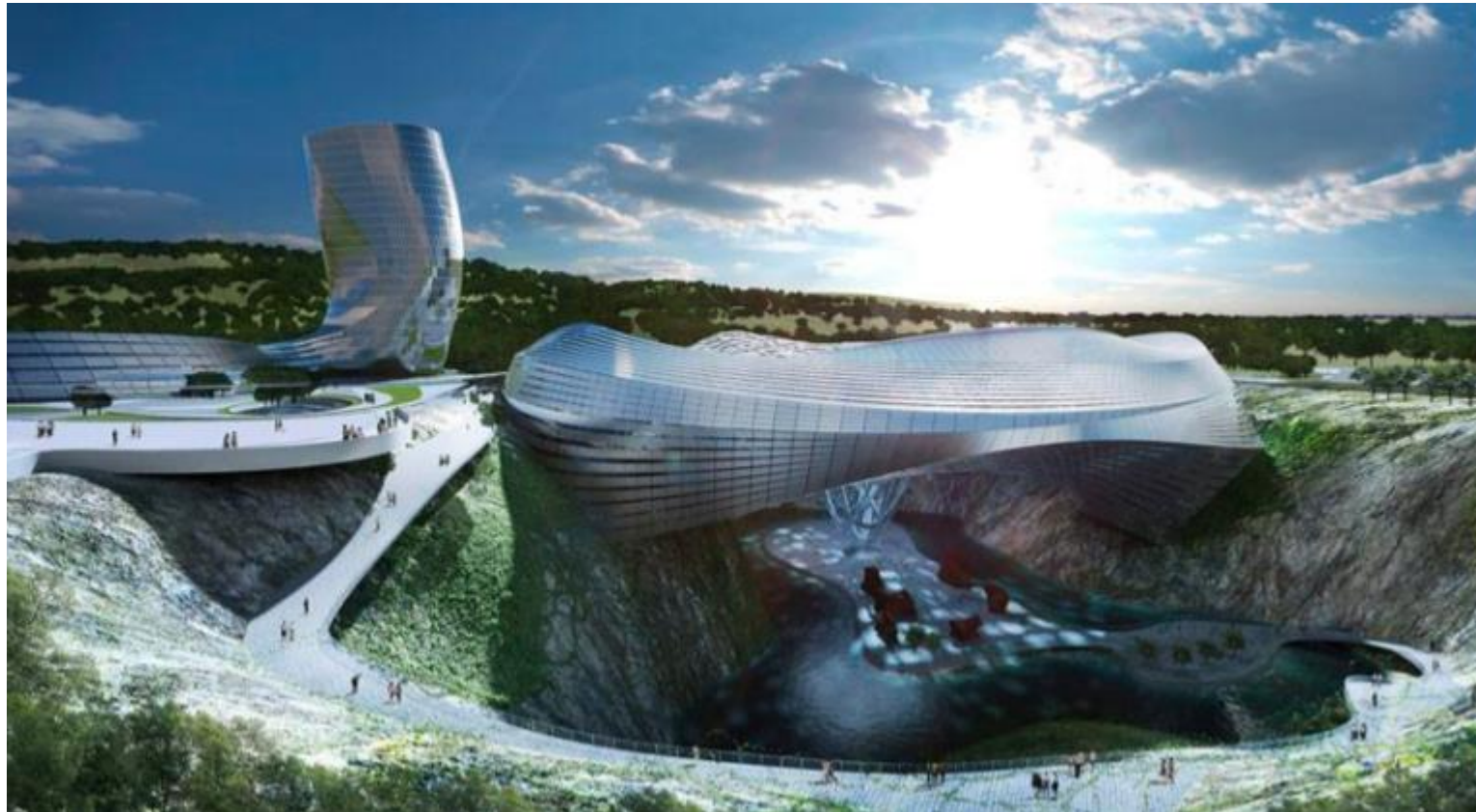

# COMPONENTS OF NEIGHBORHOOD

## ➤ THE ELEMENTS DEFINING SPACE

### ❖ Exercise

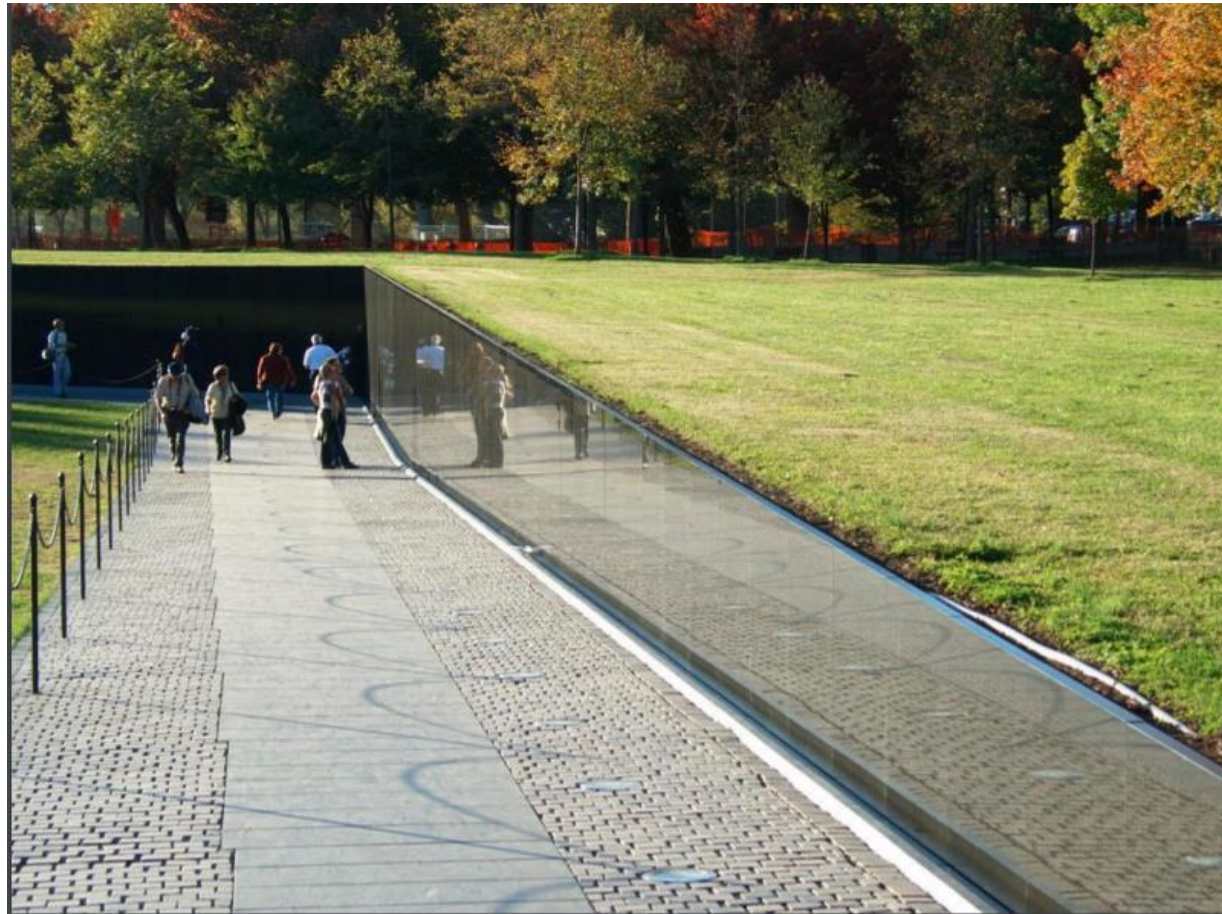

# COMPONENTS OF NEIGHBORHOOD

## ➤ THE ELEMENTS DEFINING SPACE

### ❖ Exercise



# COMPONENTS OF NEIGHBORHOOD

## ➤ THE ELEMENTS DEFINING SPACE

### ❖ Vertical Elements Defining Space:

1- **SINGLE VERTICAL ELEMENTS:** Defining the perpendicular edges of a volume of space.

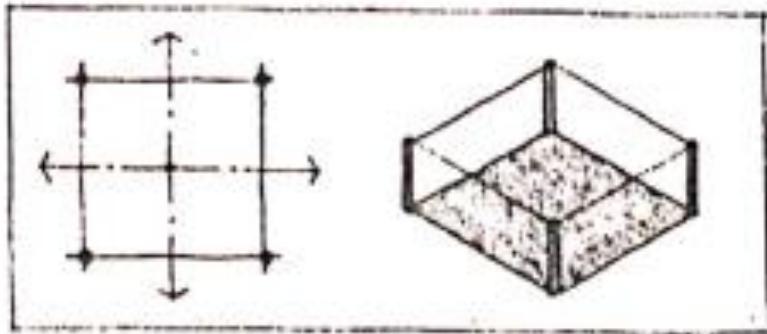

2- **SINGLE VERTICAL PLANE:** Articulates the space on which it fronts.

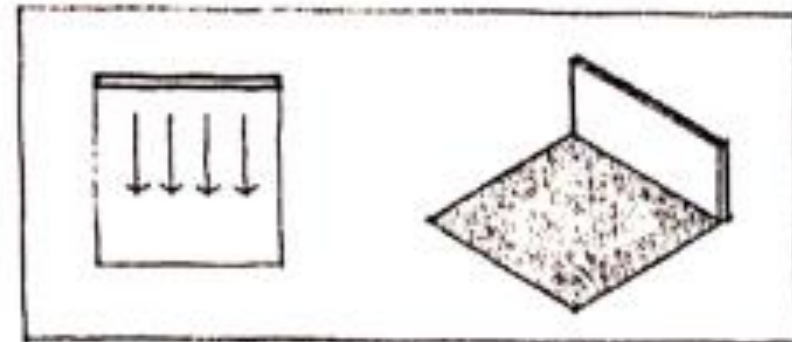



# COMPONENTS OF NEIGHBORHOOD

## ➤ THE ELEMENTS DEFINING SPACE

### ❖ Vertical Elements Defining Space:

3- **L-SHAPE PLANE:** Generates a field of space from its corner outward along a diagonal axis.

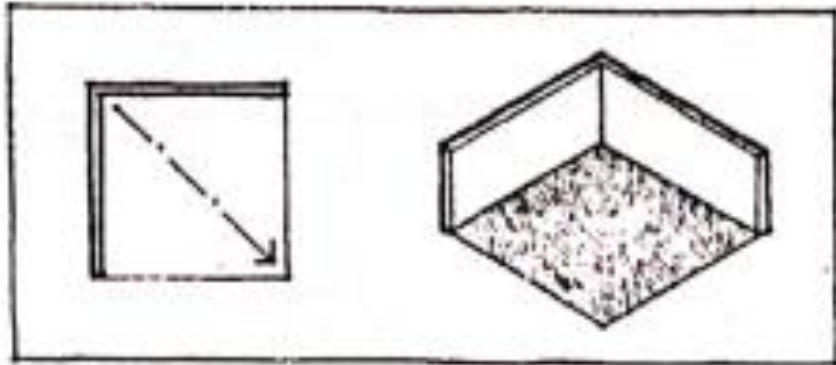

4- **PARALLEL PLANES:** Define a volume of space between them that is oriented axially both open ends.

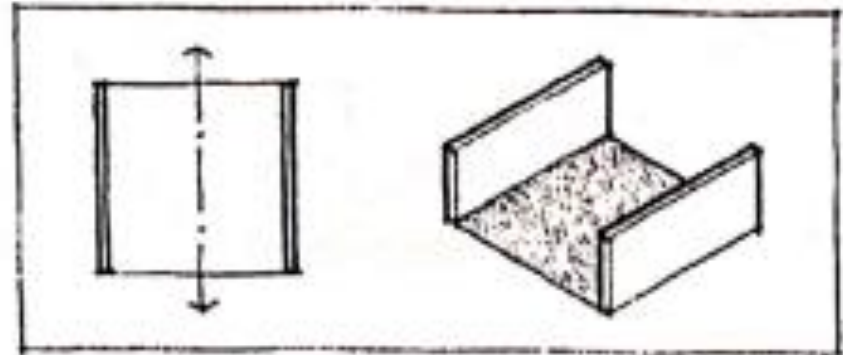

# COMPONENTS OF NEIGHBORHOOD

## ➤ THE ELEMENTS DEFINING SPACE

### ❖ Vertical Elements Defining Space:

5- **U-SHAPE PLANE:** Defines a volume of space that is oriented to open ends.

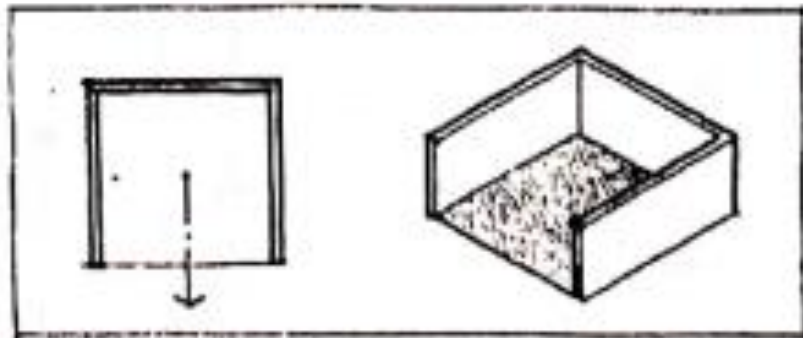

### 6- **FOUR PLANES:**

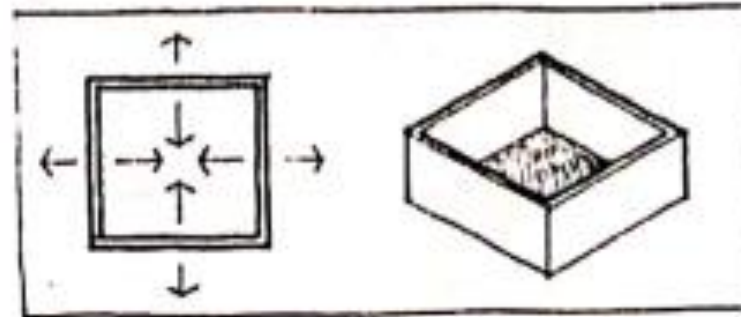

# COMPONENTS OF NEIGHBORHOOD

## ➤ THE ELEMENTS DEFINING SPACE

### ❖ Vertical Elements Defining Space:

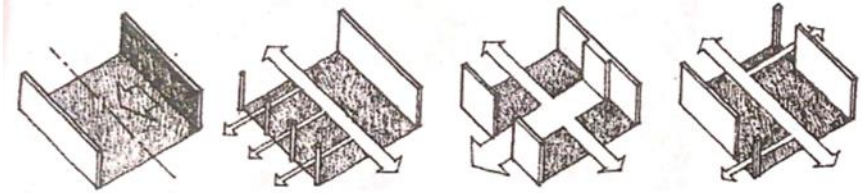
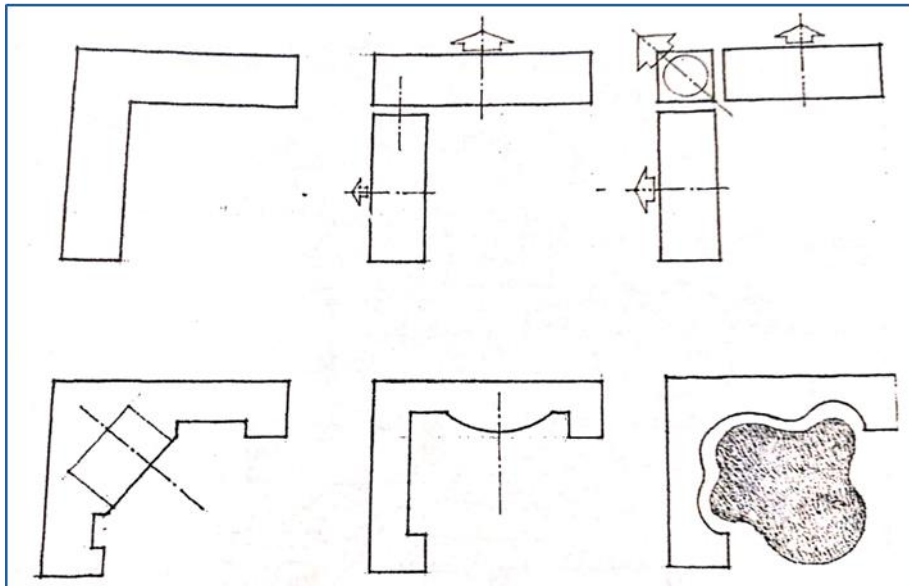

If one of the parallel planes is differentiated from the other by a change in form, color, or texture, a secondary axis, perpendicular to the flow of the space, will be established within the field. Openings in one or both of the planes can also introduce secondary axes to the field and modulate the directional quality of the space.

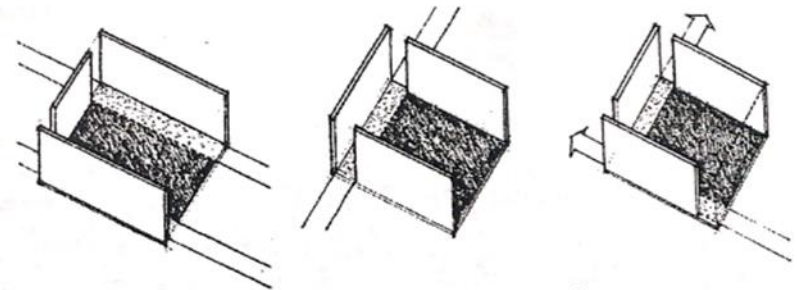

If openings are introduced at the corners of the configuration, secondary zones will be created within a multidirectional and dynamic field.

# COMPONENTS OF NEIGHBORHOOD

## ➤ THE ELEMENTS DEFINING SPACE

### ❖ Design Principles:

#### I- Clarity of Spaces

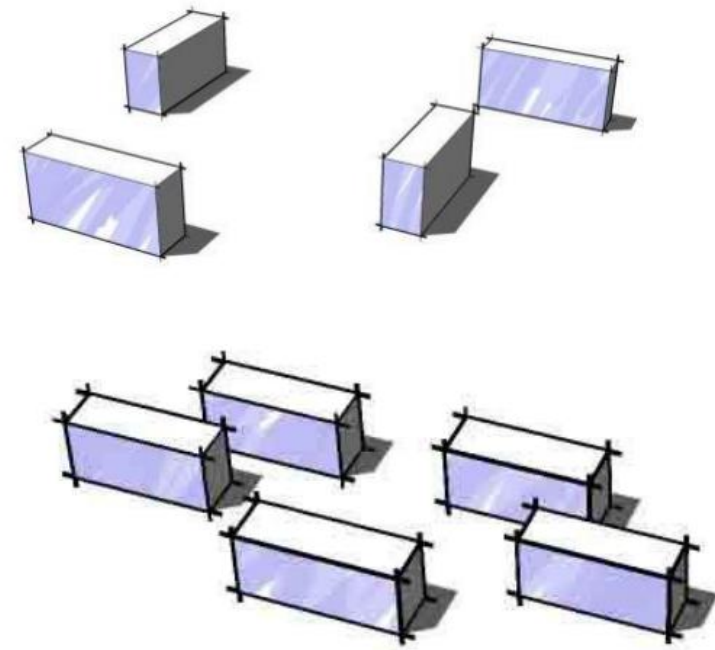
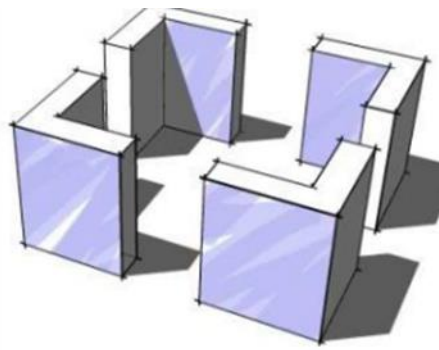
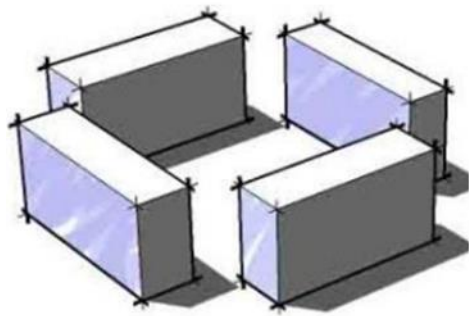

# COMPONENTS OF NEIGHBORHOOD

## ➤ THE ELEMENTS DEFINING SPACE

### ❖ Design Principles:

#### 2- Relation between spaces:

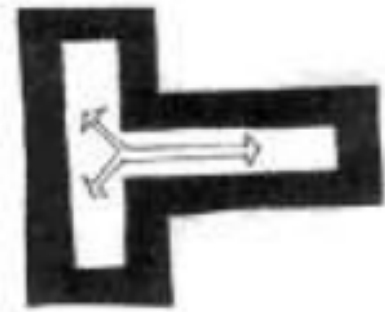

DIRECT RELATION



علاقة شبه مباشرة

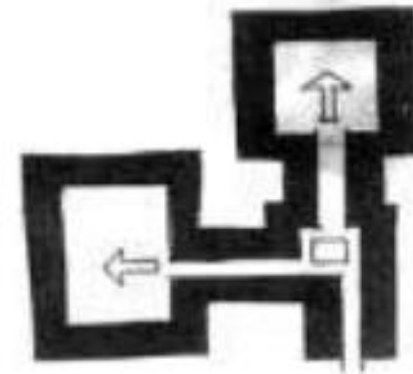

INDIRECT RELATION

# COMPONENTS OF NEIGHBORHOOD

## ➤ THE ELEMENTS DEFINING SPACE

❖ Design Principles:

2- Relation between spaces:

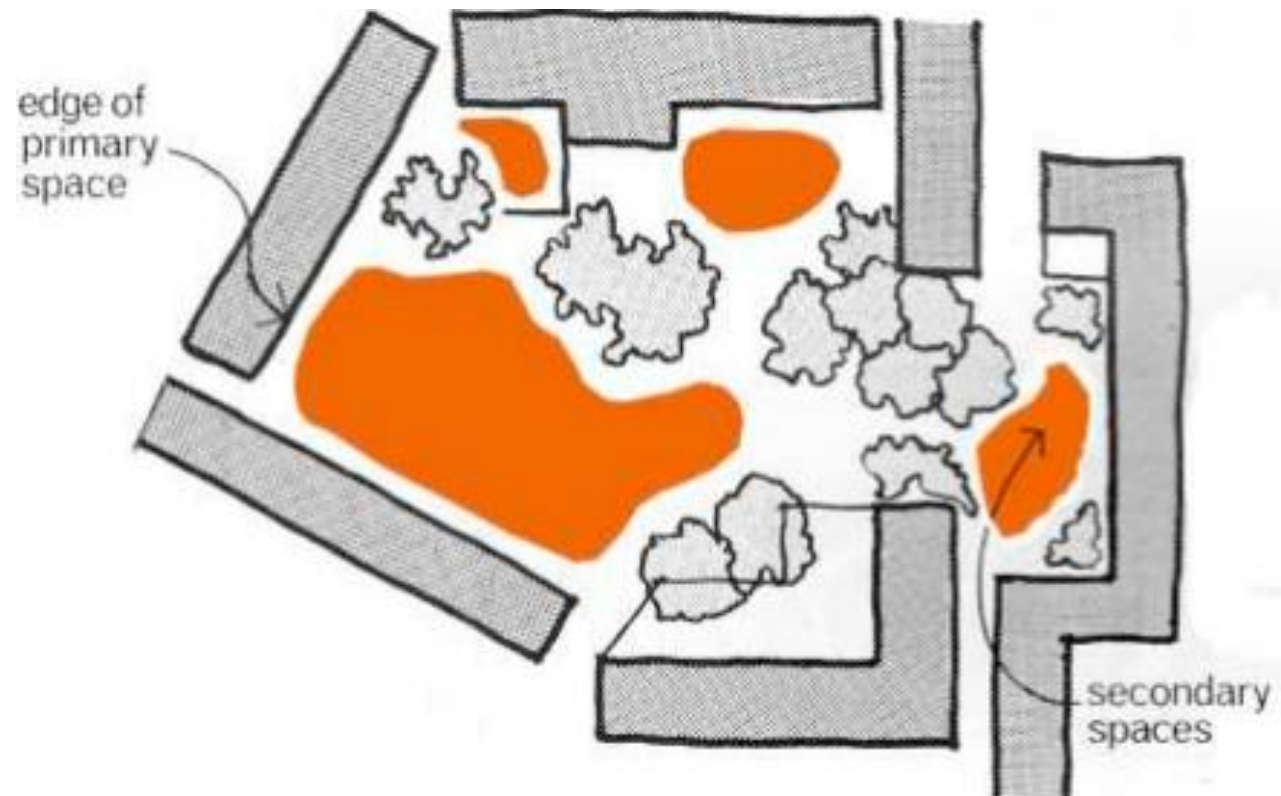

# COMPONENTS OF NEIGHBORHOOD

## ➤ THE ELEMENTS DEFINING SPACE

### ❖ Design Principles:

#### 2- Relation between spaces:

من المهم تصميم شبكة الفراغات بحيث تكون متصلة. فكل فراغ يؤدي بدوره إلى الفراغ الذي يليه.

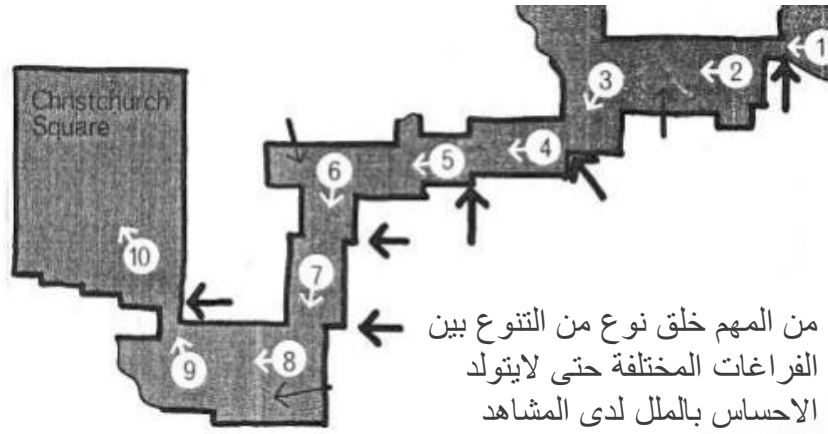

من المهم خلق نوع من التنوع بين الفراغات المختلفة حتى لا يتولد الاحساس بالملل لدى المشاهد



تعطى الفراغات الغير متصلة شعور بالإنقطاع و تخلق لدى المشاهد أحساس بالمتاهة



تعطى الفراغات المتصلة شعور بالإستمتاع والترقب والإستمرارية لدى المشاهد

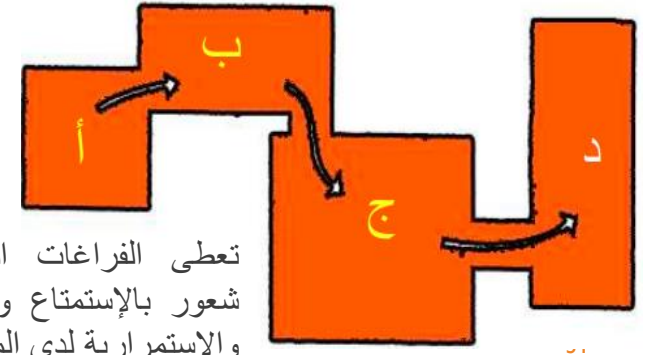

# COMPONENTS OF NEIGHBORHOOD

## ➤ THE ELEMENTS DEFINING SPACE

### ❖ Design Principles:

#### 2- Hierarchy of spaces:

نسق	الإستخدام	تدرج الفراغ
	منزل	فراغ خاص
	مبنى وله حديقة على الطريق	فراغ شبه خاص (يشترك فيه اقل من 25 أسرة)
	حديقة مبنى وسط مجموعة سكنية	فراغ شبه عام
	مجموعة سكنية / ميدان	فراغ عام



# COMPONENTS OF NEIGHBORHOOD

## ➤ THE ELEMENTS DEFINING SPACE

### ❖ Design Principles:

#### 3- Proportion of spaces:

• النسبة العظمى (الإرتفاع إلى العرض) = 1:2.5

• أكبر من ذلك تعطى إحساس بعدم الإحتواء

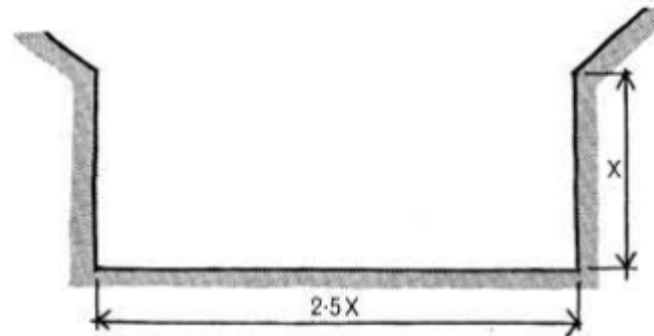

• النسبة الصغرى (الإرتفاع إلى العرض) = 1:1

• أقل من ذلك تعطى إحساس بالرهبة والخوف

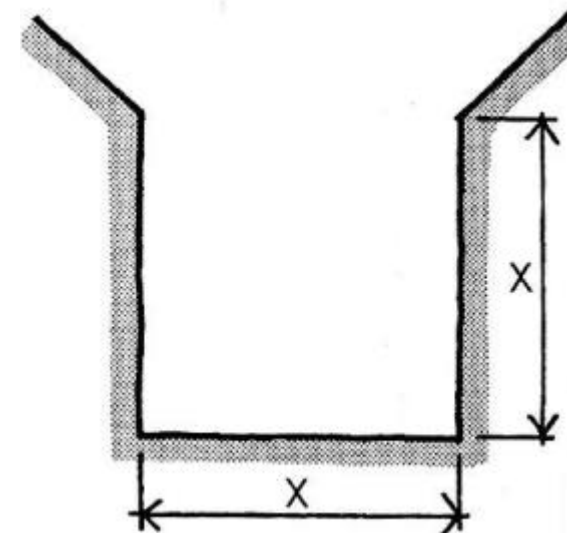

# COMPONENTS OF NEIGHBORHOOD

## ➤ THE ELEMENTS DEFINING SPACE

### ❖ Design Principles:

#### 4- Articulation of spaces:

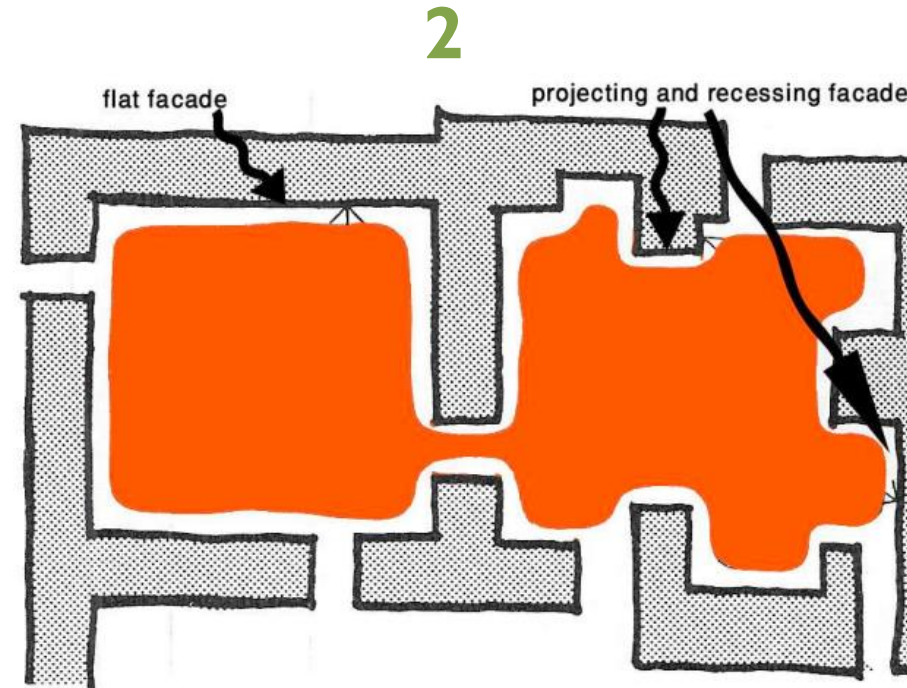
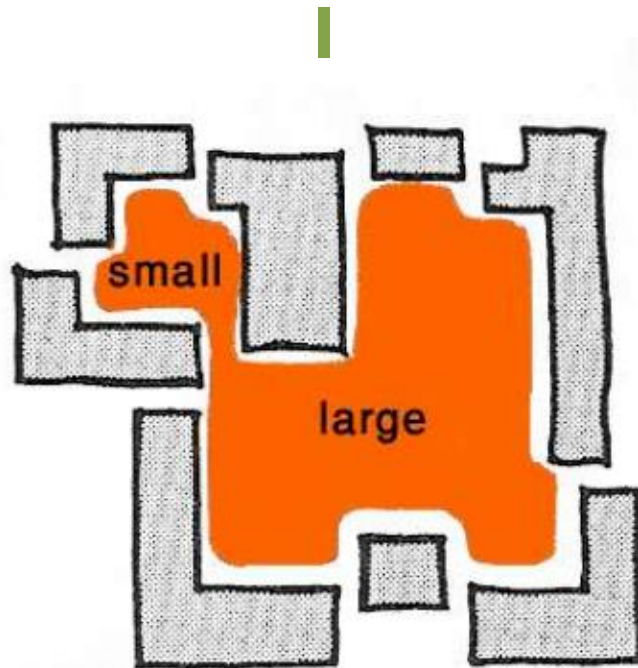

# COMPONENTS OF NEIGHBORHOOD

## ➤ THE ELEMENTS DEFINING SPACE

### ❖ Design Principles:

#### 4- Articulation of spaces:

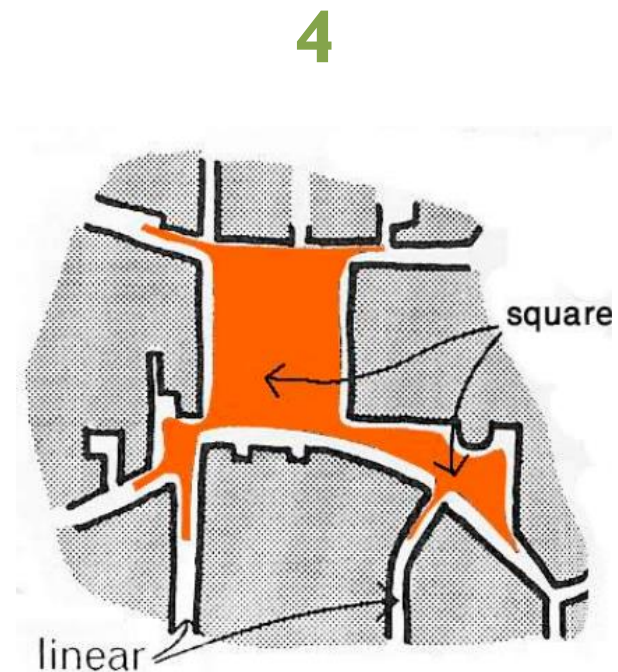
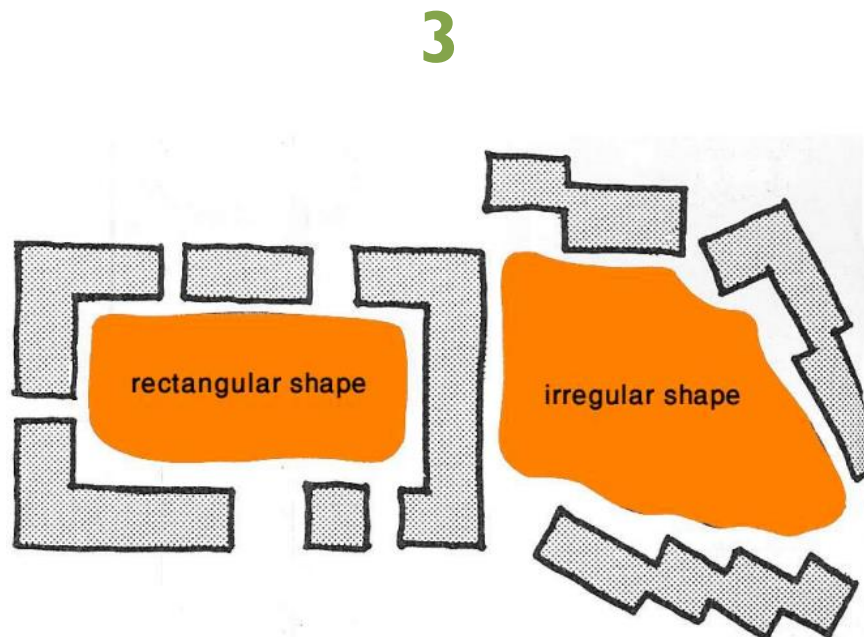

# COMPONENTS OF NEIGHBORHOOD

## ➤ THE ELEMENTS DEFINING SPACE

### ❖ Design Principles:

#### 4- Articulation of spaces:

5



2 storey

3 storey

mixed

---

# Little Learning MOMENTS

# ASSIGNMENT 4

Analyze the following open spaces:

1

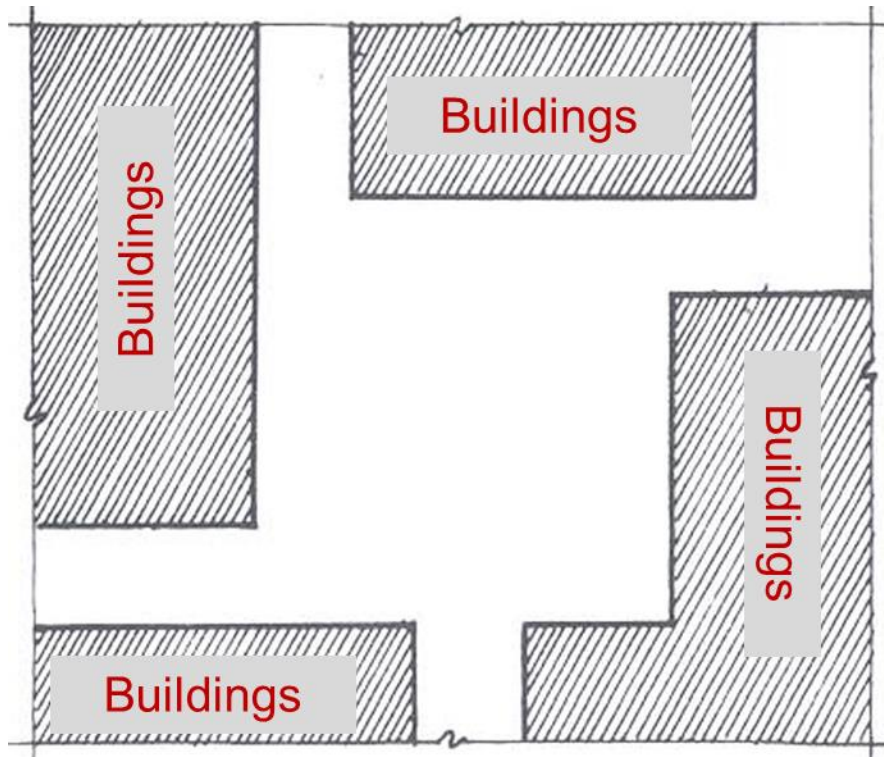

2

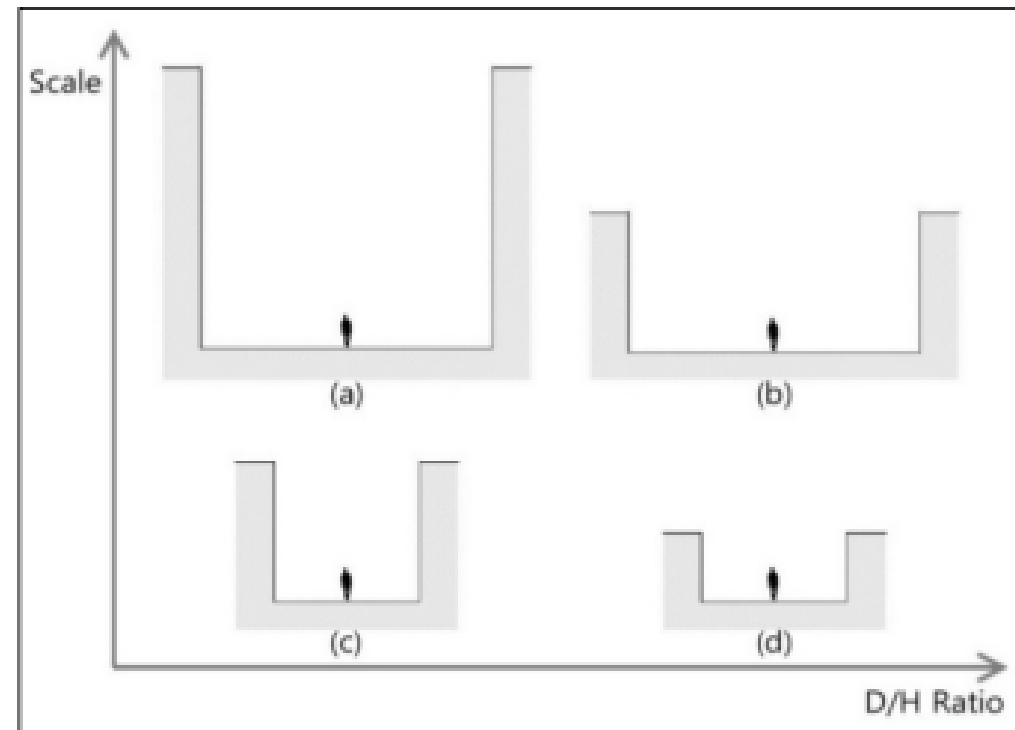

# ASSIGNMENT 4

Analyze the following open spaces:

3

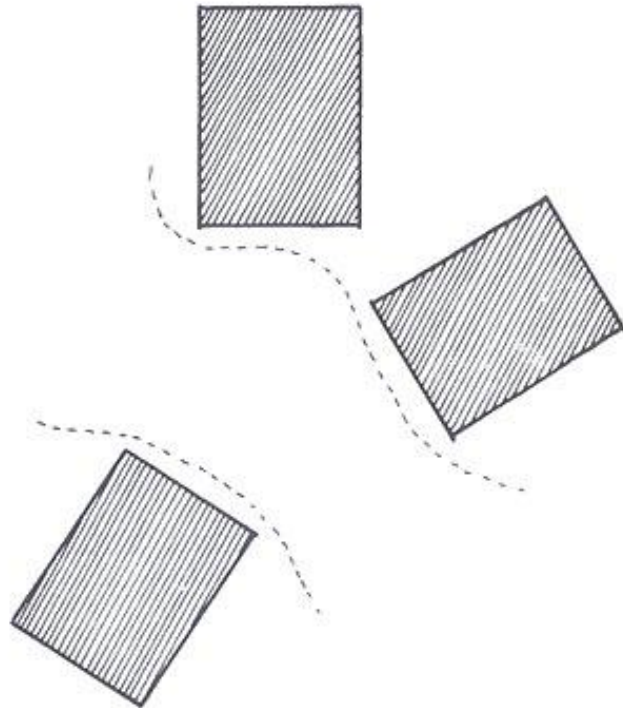

4

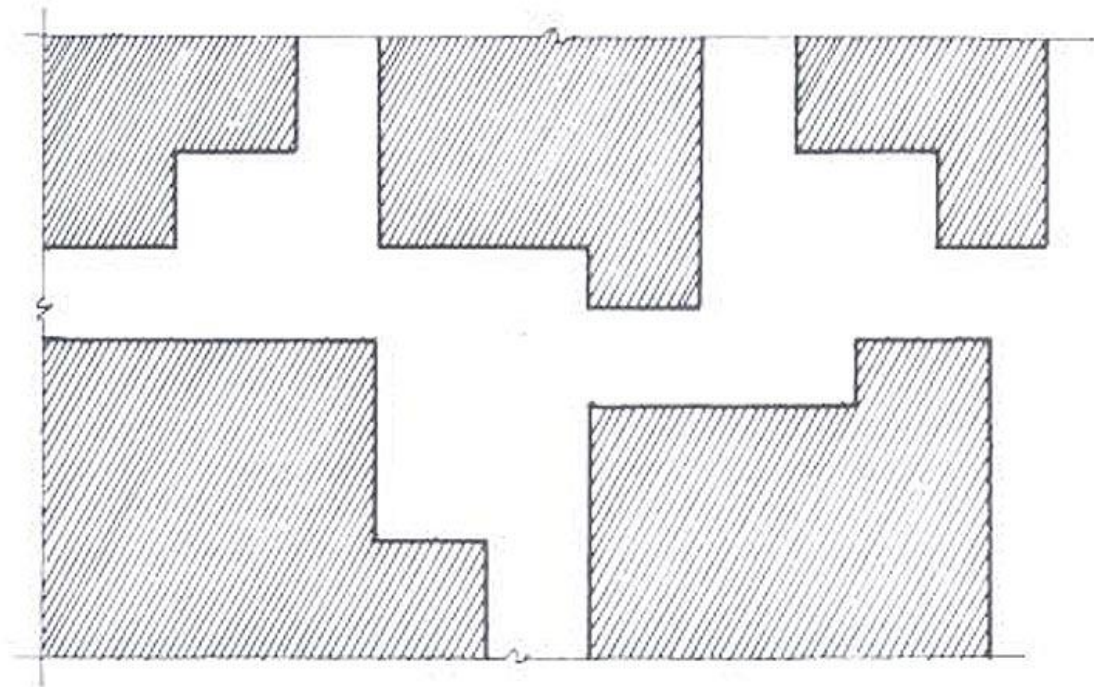



**ANY QUESTIONS?????**

THANK YOU....





The references to multiple sources are text & figures  
(sketches, drawings, pictures, photos,..etc.)

**ALL THE RIGHTS BELONG TO ORIGINAL  
AUTHORS**